

Inventory of Properties
Listed on the
State and National Registers of
Historical Places

Town of Rochester
Ulster County, New York

Published by:
The Rochester Residents Association, Inc.
October 31, 2002

Table of Contents

Survey of Properties on the
State and National Register of Historical Places
in the Town of Rochester, Ulster County, New York
as of October 31, 2002

Krom Stone House & Dutch Barn	3
Sebastian Baker Stone House	4
Van Wagenen Stone House & Farm Complex	5
Jacobus Van Wagenen Stone House	6
Middaugh Stone House & Dutch Barn	7
Dirck Westbrook Stone House	8
C.K. Schoonmaker Stone House	9
Davis Stone House	10
Johannes Rider Stone House	11
Krom Stone House at 31 Upper Whitfield Road	12
Krom Stone House at 45 Upper Whitfield Road	13
Hornbeck Stone House	14
Ephriam DuPuy Stone House	15
Jacob F. Markle Stone House	16
Winfield Corners Stone House	17
Stilwell-Westbrook Stone House	18
Jacob Hoornbeck Stone House	19
Sahler Stone House	20
Sahler Stone House & Dutch Barn	21
Lucas Krom Stone House	22
Schoonmaker Stone House & Farm	23
Zacharia Barley Stone House	24
J. Sahler Stone House	25
Terwilliger-Smith Farm¹	26
Stillwell Stone House	27
J. DePuy Stone House	28
Common School No. 10	29

Downloadable copies of this report are available free of charge at www.Accord-Kerhonkson.com
The complete National Register of Historical Places is available at
www.nationalregisterofhistoricplaces.com/ny/ulster/state.html

All rights reserved
For more information contact resident@accord-kerhonkson.com

¹ Approved for State Listing in September 2002, nominated for National Listing.

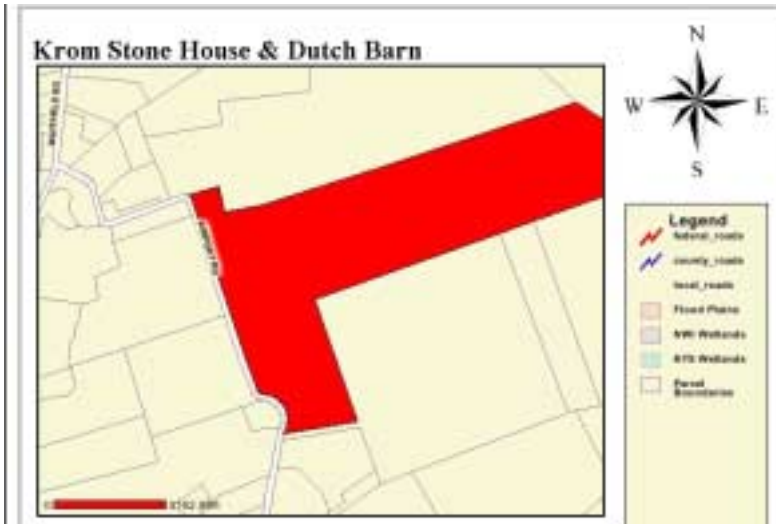

69.3-2-44
 234 Airport Road
 92.70 acres

Krom Stone House and Dutch Barn (added 1995 - **Building** - #95000955)

Airport Rd., Rochester

Historic Significance:	Architecture/Engineering
Architect, builder, or engineer:	Unknown
Architectural Style:	No Style Listed
Area of Significance:	Architecture
Period of Significance:	1700-1749, 1750-1799, 1850-1874
Owner:	Private
Historic Function:	Agriculture/Subsistence, Domestic
Historic Sub-function:	Agricultural Outbuildings, Secondary Structure, Single Dwelling
Current Function:	Domestic
Current Sub-function:	Secondary Structure, Single Dwelling



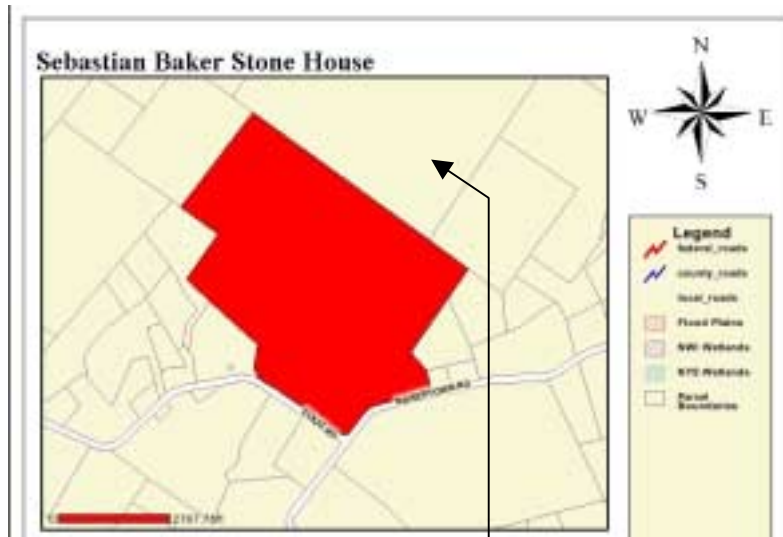

Common Ownership

10 Dug Road
 68.2-2-44.110 & 68.2-2-45
 63.10 acres & 100 acres

Baker, Sebastian, Stone House (added 1996 - **Building** - #96000136)

10 Dug Rd., Rochester

Historic Significance: Architecture/Engineering

Area of Significance: Architecture

Period of Significance: 1750-1799, 1900-1924

Owner: **Private**

Historic Function: Agriculture/Subsistence, Domestic

Historic Sub-function: Agricultural Outbuildings, Secondary Structure, Single Dwelling

Current Function: Agriculture/Subsistence, Domestic, Funerary

Current Sub-function: Agricultural Outbuildings, Cemetery, Secondary Structure, Single Dwelling



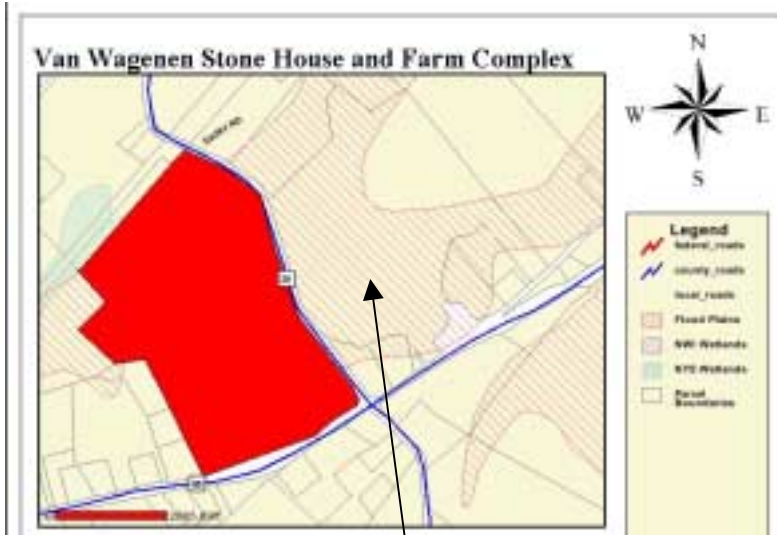

2732 Lucas Turnpike
 69.4-2-22 & 69.4-2-15
 70.60 acres & 54.6 acres

Common Ownership

Van Wagenen Stone House and Farm Complex (added 1999 - **Building** - #99000994)

Also known as **Het Killities Landt**

2732 Lucas Turnpike, Rochester

- Historic Significance: Architecture/Engineering
- Architectural Style: Colonial, Federal
- Area of Significance: Architecture
- Period of Significance: 1700-1749, 1750-1799, 1800-1824, 1825-1849, 1850-1874, 1875-1899
- Owner: **Private**
- Historic Function: Agriculture/Subsistence, Domestic
- Historic Sub-function: Animal Facility, Single Dwelling, Storage
- Current Function: Agriculture/Subsistence, Domestic
- Current Sub-function: Animal Facility, Single Dwelling, Storage





2659 Lucas Turnpike
 69.4-2-17
 9.30 acres

Van Wageningen, Jacobus, Stone House (added 1999 - **Building** - #99000999)

2659 Lucas Turnpike, Rochester

Historic Significance:	Architecture/Engineering
Architectural Style:	Colonial
Area of Significance:	Architecture
Period of Significance:	1750-1799
Owner:	Private
Historic Function:	Domestic
Historic Sub-function:	Single Dwelling
Current Function:	Domestic
Current Sub-function:	Single Dwelling



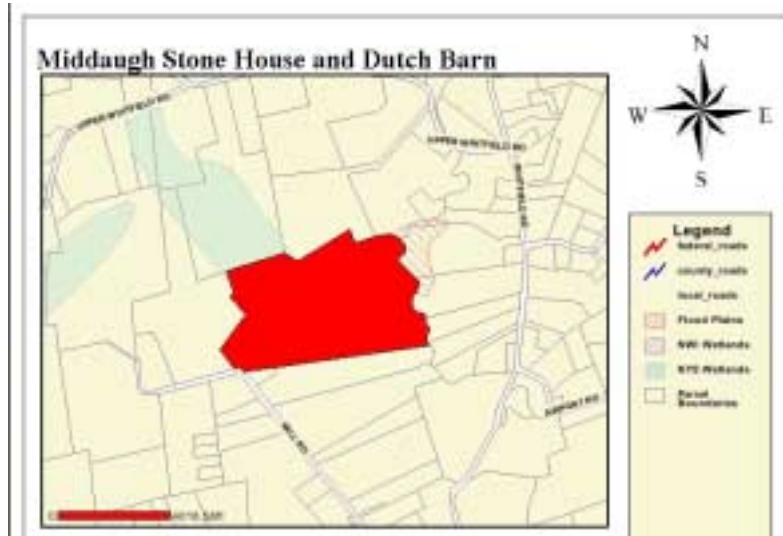

476 Mill Hook Road
 69.3-1-2.120
 55.75 acres
 aka Benjamin Rider House
 Plus Fields

Middaugh--Stone House and Dutch Barn (added 1994 - **Building** - #94001514)

476 Mill Rd., Rochester

Historic Significance:	Architecture/Engineering
Architect, builder, or engineer:	Unknown
Architectural Style:	No Style Listed
Area of Significance:	Architecture
Period of Significance:	1750-1799, 1875-1899
Owner:	Private
Historic Function:	Agriculture/Subsistence, Domestic, Funerary
Historic Sub-function:	Agricultural Outbuildings, Cemetery, Single Dwelling
Current Function:	Agriculture/Subsistence, Domestic, Funerary
<u>Current Sub-function:</u>	Agricultural Outbuildings, Cemetery, Single Dwelling

No Photo Available



18 Old Whitfield Rd.
 69.3-1-24
 4.50 acres

Westbrook, Dirck, Stone House (added 1995 - **Building** - #95000949)

18 Old Whitfield Rd., Rochester

Historic Significance:	Architecture/Engineering
Architect, builder, or engineer:	Unknown
Architectural Style:	No Style Listed
Area of Significance:	Architecture
Period of Significance:	1700-1749, 1850-1874, 1925-1949
Owner:	Private
Historic Function:	Domestic
Historic Sub-function:	Secondary Structure, Single Dwelling
Current Function:	Domestic
Current Sub-function:	Secondary Structure, Single Dwelling





294 Queens Highway
 68.4-6-21.100 & 64.8-6-1.200
 4.20 acres & 26.8 acres

Common Ownership

Schoonmaker, C. K., Stone House (added 1997 - **Building** - #97000107)

294 Queens Hwy., Rochester

Historic Significance:	Architecture/Engineering
Architectural Style:	No Style Listed
Area of Significance:	Architecture
Period of Significance:	1825-1849
Owner:	Private
Historic Function:	Domestic
Historic Sub-function:	Single Dwelling
Current Function:	Domestic
Current Sub-function:	Single Dwelling



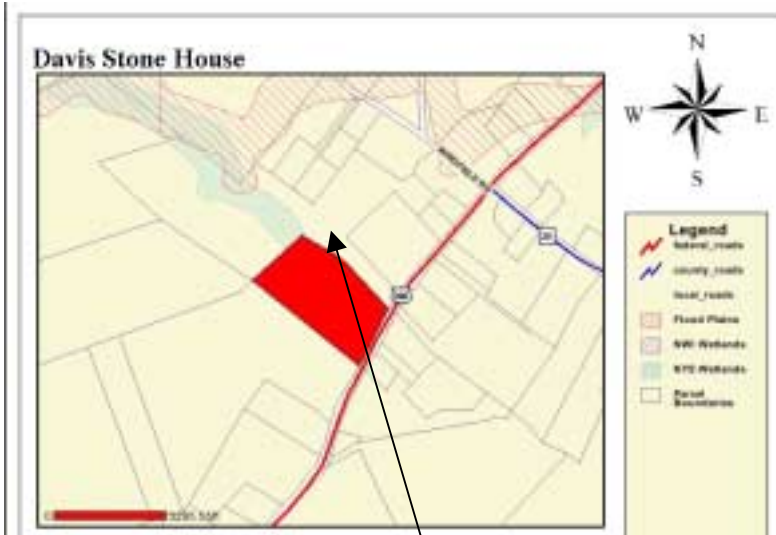

Common Ownership

4652 Route 209
 69.3-2-10
 15.50 acres and 69.3-2-3 39.3 acres

Davis Stone House (added 1999 - **Building** - #99000995)
 4652 NY 209, Rochester

Historic Significance:	Architecture/Engineering
Architectural Style:	Colonial
Area of Significance:	Architecture
Period of Significance:	1750-1799, 1800-1824, 1825-1849, 1850-1874, 1875-1899, 1900-1924
Owner:	Private
Historic Function:	Domestic
Historic Sub-function:	Single Dwelling
Current Function:	Domestic
Current Sub-function:	Single Dwelling



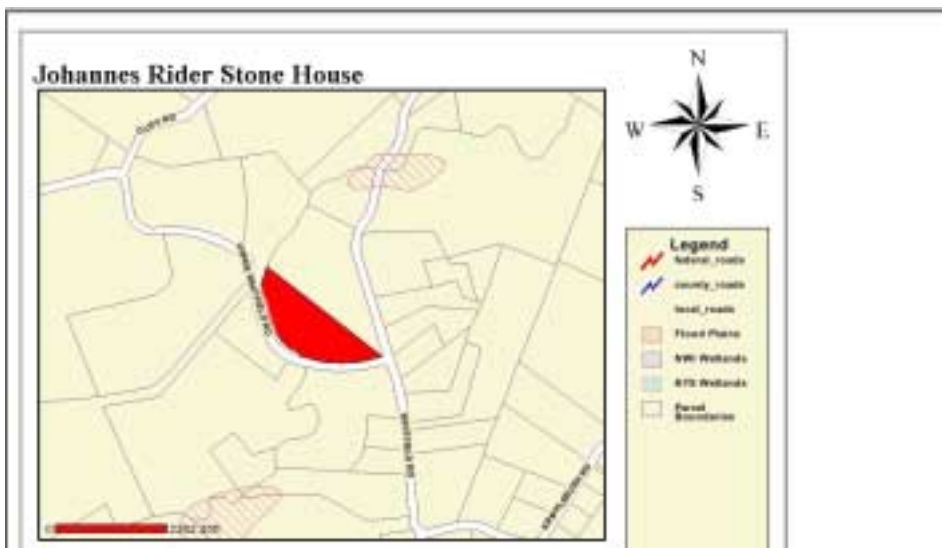

7 Upper Whitfield Road
 69.1-1-14.200
 4.65 acres

Rider, Johannes, Stone House (added 1995 - **Building** - #95000956)

7 Upper Whitfield Rd., Rochester

Historic Significance:	Architecture/Engineering
Architect, builder, or engineer:	Unknown
Architectural Style:	No Style Listed
Area of Significance:	Architecture
Period of Significance:	1800-1824, 1875-1899
Owner:	Private
Historic Function:	Domestic
Historic Sub-function:	Secondary Structure, Single Dwelling
Current Function:	Domestic
Current Sub-function:	Secondary Structure, Single Dwelling



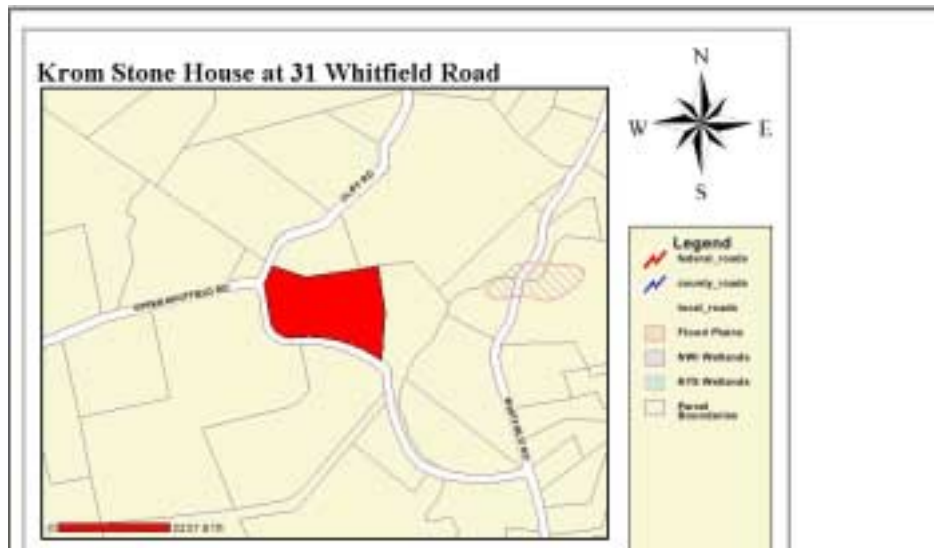

31 Upper Whitfield Rd.
 69.1-1-23
 6.90 acres

Krom Stone House at 31 Upper Whitfield Road (added 1995 - **Building** - #95000954)

31 Upper Whitfield Rd., Rochester

Historic Significance:	Architecture/Engineering
Architect, builder, or engineer:	Unknown
Architectural Style:	No Style Listed
Area of Significance:	Architecture
Period of Significance:	1750-1799
Owner:	Private
Historic Function:	Domestic
Historic Sub-function:	Single Dwelling
Current Function:	Domestic
Current Sub-function:	Single Dwelling





45 Upper Whitfield Rd.
 68.2-2-24
 8.12 acres

Krom Stone House at 45 Upper Whitfield Road (added 1995 - **Building** - #95000950)

45 Upper Whitfield Rd., Rochester

Historic Significance:	Architecture/Engineering
Architect, builder, or engineer:	Unknown
Architectural Style:	No Style Listed
Area of Significance:	Architecture
Period of Significance:	1750-1799, 1875-1899
Owner:	Private
Historic Function:	Domestic
Historic Sub-function:	Single Dwelling
Current Function:	Domestic
Current Sub-function:	Single Dwelling



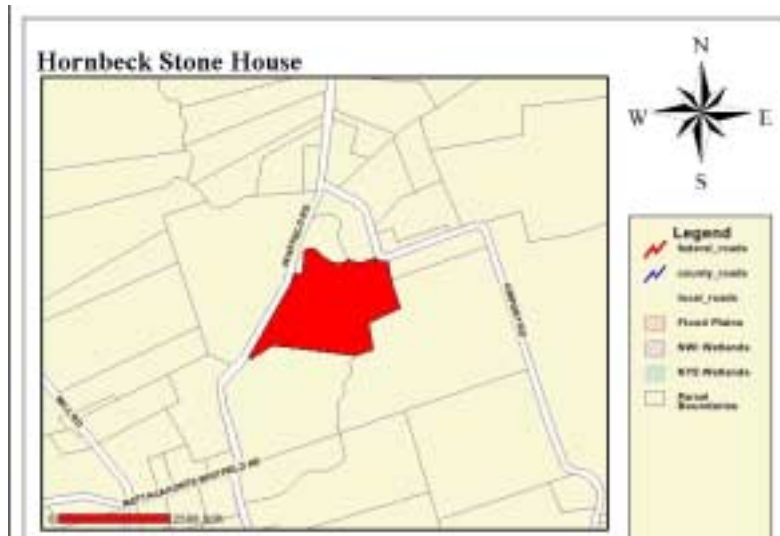

149 Whitfield Road
 69.3-1-12.110
 11.3 acres

Hornbeck Stone House (added 1995 - **Building** - #95000957)

149 Whitfield Rd., Rochester

Historic Significance:	Architecture/Engineering
Architect, builder, or engineer:	Unknown
Architectural Style:	No Style Listed
Area of Significance:	Architecture
Period of Significance:	1750-1799
Owner:	Private
Historic Function:	Domestic
Historic Sub-function:	Secondary Structure, Single Dwelling
Current Function:	Domestic
Current Sub-function:	Secondary Structure, Single Dwelling



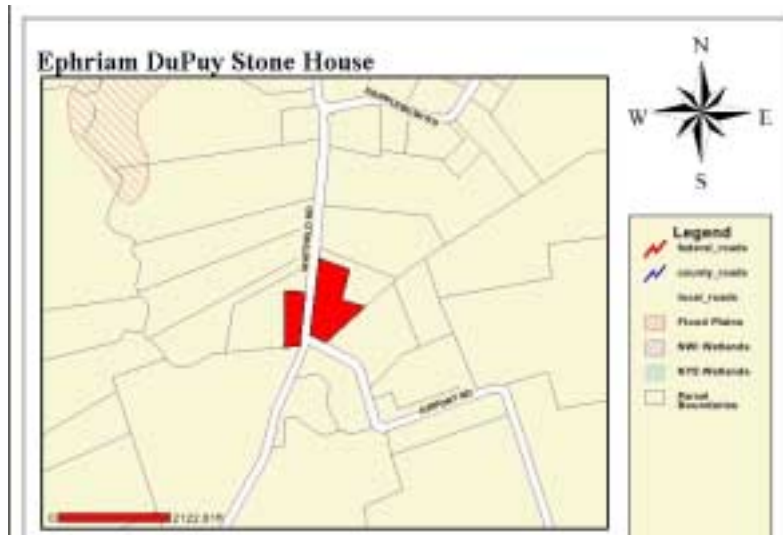

193 Whitfield Road
 69.3-1-6.112
 3.10 acres

DuPuy, Ephriam, Stone House (added 1995 - **Building** - #95000952)

193 Whitfield Rd., Rochester

Historic Significance:	Architecture/Engineering
Architectural Style:	No Style Listed
Area of Significance:	Architecture
Period of Significance:	1750-1799, 1850-1874
Owner:	Private
Historic Function:	Domestic
Historic Sub-function:	Secondary Structure, Single Dwelling
Current Function:	Domestic
Current Sub-function:	Secondary Structure, Single Dwelling



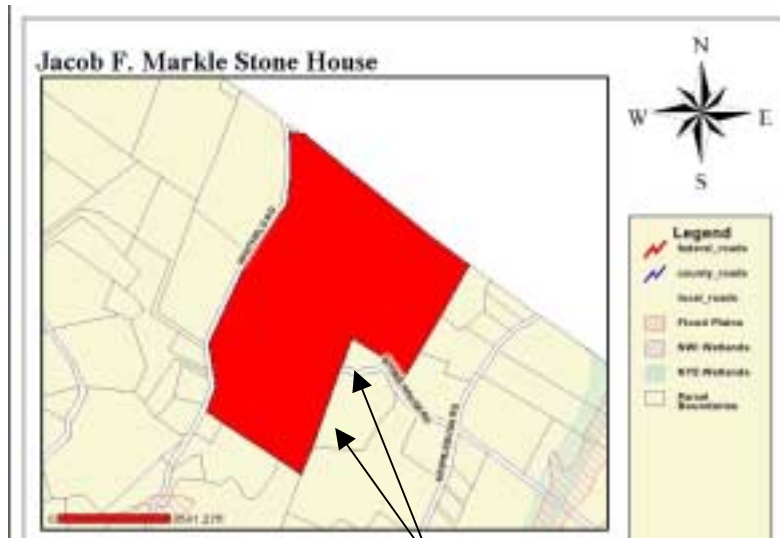

Common Ownership

335 Whitfield Road
 69.1-1-3.100 & 69.1-2-48
 91.7 acres & 11 acres

Markle, Jacob F., Stone House (added 1995 - **Building** - #95000948)

335 Whitfield Rd., Rochester

Historic Significance:	Architecture/Engineering
Architectural Style:	No Style Listed
Area of Significance:	Architecture
Period of Significance:	1750-1799, 1875-1899
Owner:	Private
Historic Function:	Domestic
Historic Sub-function:	Secondary Structure, Single Dwelling
Current Function:	Domestic
Current Sub-function:	Secondary Structure, Single Dwelling



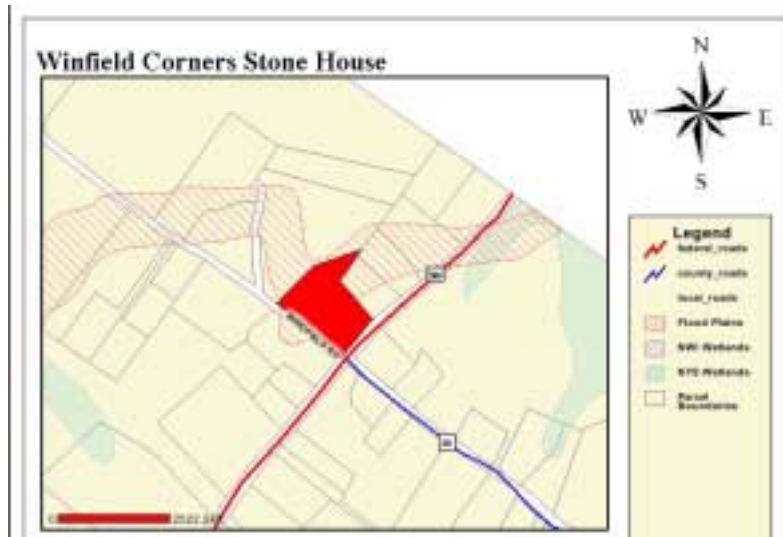

16 Winfield Road
 69.3-2-6.200
 5.74 acres

Winfield Corners Stone House (added 1999 - **Building** - #99000993)

Winfield Rd., Rochester

Historic Significance:	Architecture/Engineering
Architectural Style:	Colonial
Area of Significance:	Architecture
Period of Significance:	1700-1749, 1750-1799, 1800-1824, 1825-1849, 1850-1874
Owner:	Private
Historic Function:	Domestic
Historic Sub-function:	Single Dwelling
Current Function:	Domestic
Current Sub-function:	Single Dwelling



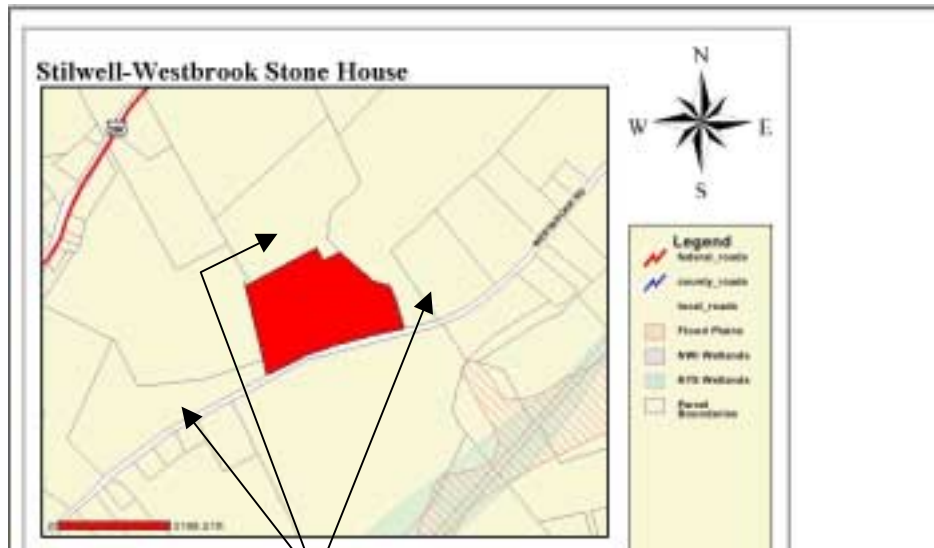

482 Old Kings Highway
 69.3-3-23
 20.51 acres

Common Ownership

Stilwell--Westbrook Stone House (added 1999 - **Building** - #99000997)

482 Old Kings Highway, Rochester

Historic Significance:	Architecture/Engineering
Architectural Style:	Colonial, Greek Revival
Area of Significance:	Architecture
Period of Significance:	1750-1799, 1800-1824, 1825-1849, 1850-1874, 1875-1899
Owner:	Private
Historic Function:	Domestic
Historic Sub-function:	Single Dwelling
Current Function:	Domestic
Current Sub-function:	Single Dwelling



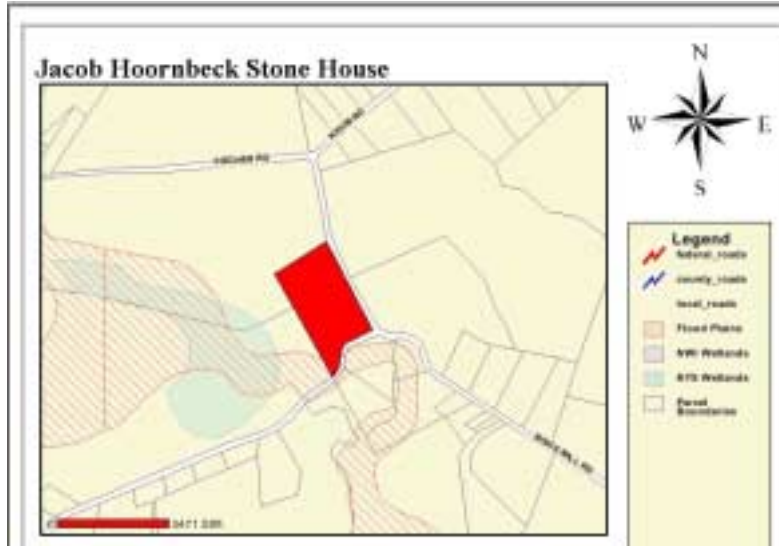

3 Dunn Farms Road
 76.1-2-2.300
 13.7 acres

Hoornbeck, Jacob, Stone House (added 1997 - **Building** - #97000108)
 Boice Mill Rd., jct. with Krum Rd., Rochester
 Historic Significance: Architecture/Engineering
 Architectural Style: No Style Listed
 Area of Significance: Architecture
 Period of Significance: 1800-1824
 Owner: **Private**
 Historic Function: Domestic
 Historic Sub-function: Single Dwelling
 Current Function: Domestic
 Current Sub-function: Single Dwelling



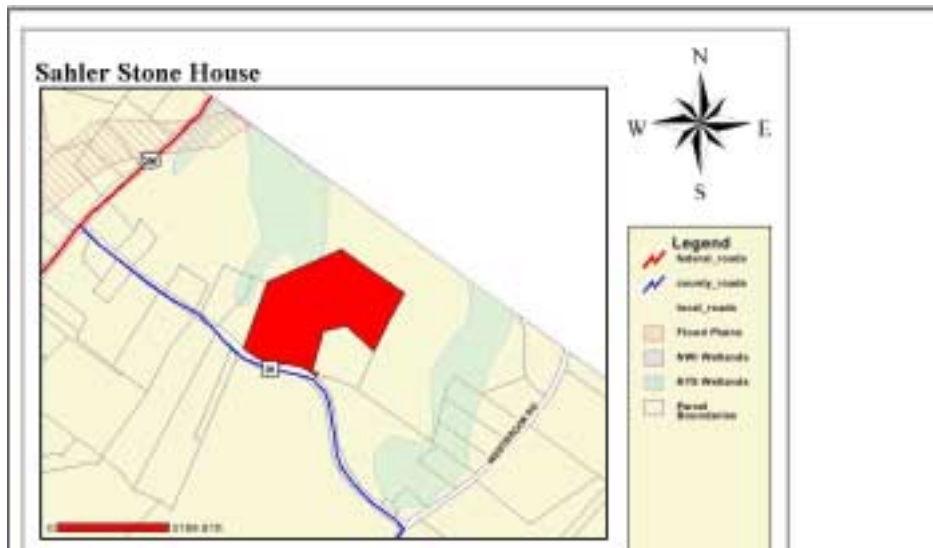

Kyserike Road (across from school)
 69.4-2-2
 20 acres

Sahler Stone House (added 1999 - **Building** - #99000992)

Kyserike Rd., Rochester

Historic Significance:	Architecture/Engineering
Architectural Style:	Colonial
Area of Significance:	Architecture
Period of Significance:	1750-1799, 1800-1824, 1825-1849, 1850-1874
Owner:	Private
Historic Function:	Domestic
Historic Sub-function:	Single Dwelling
Current Function:	Domestic
Current Sub-function:	Single Dwelling



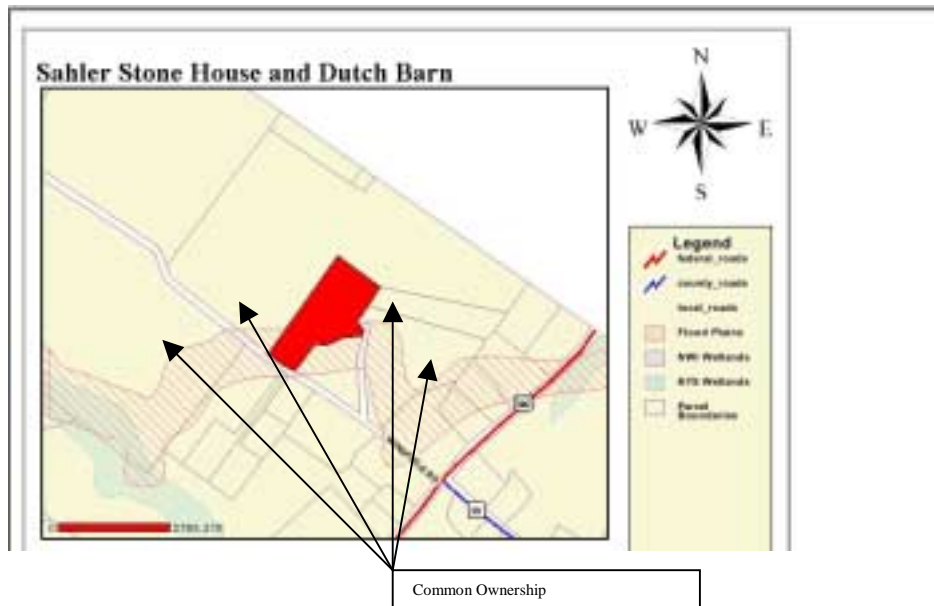

540 Winfield Corners
 69.1-2-9 & 69.1-2-11 & 69.1-2-12.100 & 69.1-2-12.200
 11.13 acres & 7 acres & 104.5 acres & 4 acres

Sahler Stone House and Dutch Barn (added 1999 - **Building** - #99000998)

Winfield Rd., Rochester

Historic Significance:	Architecture/Engineering
Architectural Style:	Colonial, Federal
Area of Significance:	Architecture
Period of Significance:	1750-1799, 1800-1824, 1825-1849
Owner:	Private
Historic Function:	Agriculture/Subsistence, Domestic
Historic Sub-function:	Animal Facility, Single Dwelling, Storage
Current Function:	Agriculture/Subsistence, Domestic
Current Sub-function:	Animal Facility, Single Dwelling, Storage



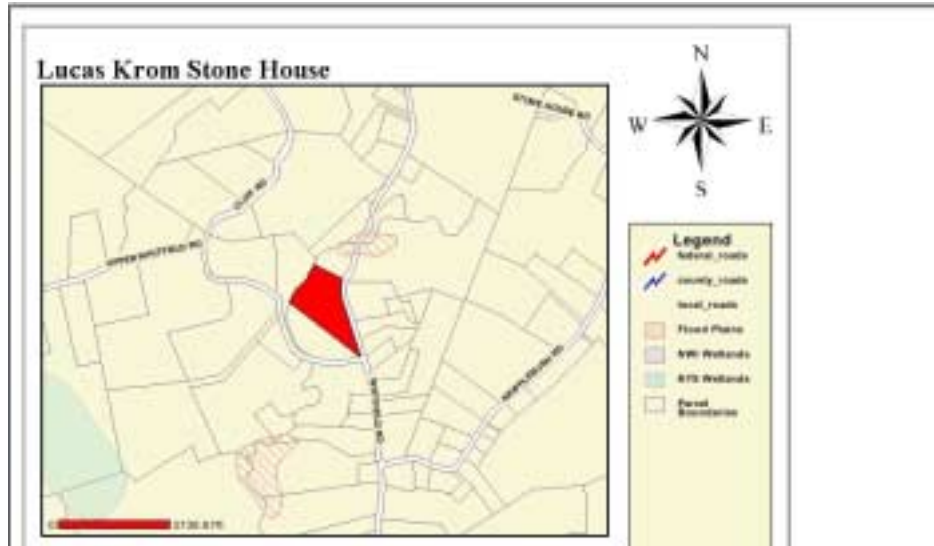

286 Whitfield Rd.
 69.1-1-26.200
 7.21 acres

Krom, Lucas, Stone House (added 1995 - **Building** - #95000953)

286 Whitfield Rd., Rochester

Historic Significance:	Architecture/Engineering
Architect, builder, or engineer:	Unknown
Architectural Style:	No Style Listed
Area of Significance:	Architecture
Period of Significance:	1750-1799, 1800-1824
Owner:	Private
Historic Function:	Domestic
Historic Sub-function:	Secondary Structure, Single Dwelling
Current Function:	Domestic
Current Sub-function:	Secondary Structure, Single Dwelling



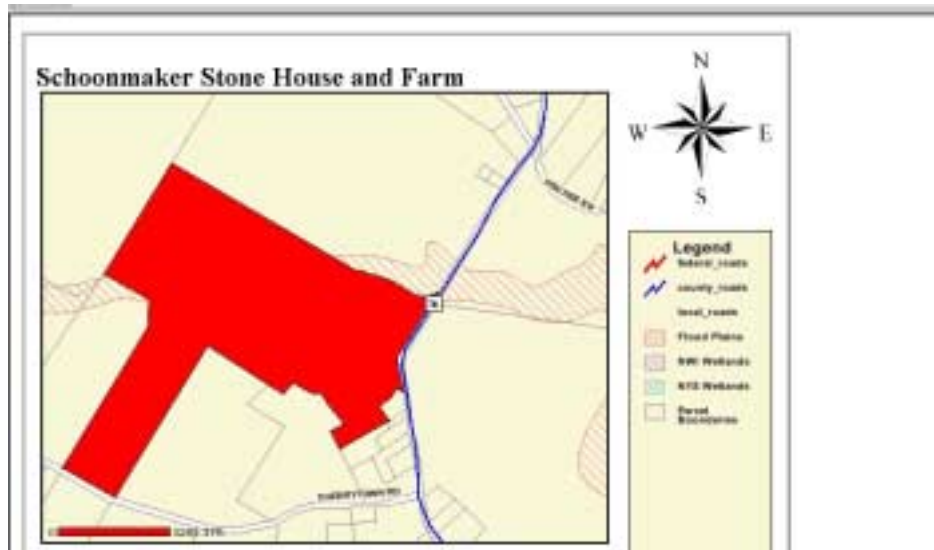

203 Samsonville Rd.
 76.1-1-1
 96 acres

Schoonmaker Stone House and Farm (added 1997 - **Building** - #97000109)
 Samsonville Rd., near jct. of NY 76 and Cherrytown Rd., Rochester
 Historic Significance: Architecture/Engineering
 Architectural Style: Federal
 Area of Significance: Architecture
 Period of Significance: 1800-1824, 1825-1849, 1850-1874, 1875-1899
 Owner: **Private**
 Historic Function: Agriculture/Subsistence, Domestic
 Historic Sub-function: Agricultural Outbuildings, Single Dwelling
 Current Function: Agriculture/Subsistence, Domestic
 Current Sub-function: Agricultural Outbuildings, Single Dwelling





90 Upper Whitfield Rd
68.4-3-13

Barley, Zachariah, Stone House (added 1995 - **Building** - #95000951)
 193 Whitfield Rd., Rochester (incorrect address on National Register)
 Historic Significance: Architecture/Engineering
 Architectural Style: No Style Listed
 Area of Significance: Architecture
 Period of Significance: 1750-1799, 1850-1874, 1875-1899
 Owner: **Private**
 Historic Function: Domestic
 Historic Sub-function: Secondary Structure, Single Dwelling
 Current Function: Domestic
 Current Sub-function: Secondary Structure, Single Dwelling



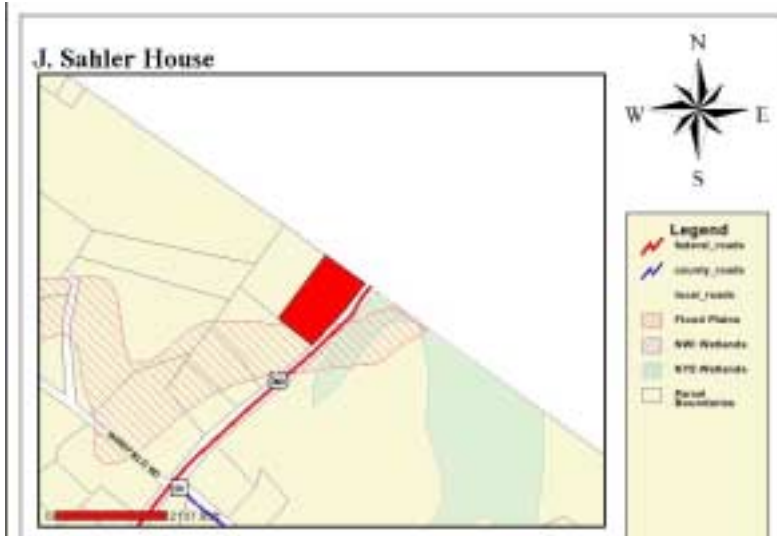

4496 Route 209
 69.4-2-1.320
 2.9 acres

Sahler, J., House (added 2000 - **Building** - #97000118)

Also known as **Elm Rock**

NY 209, SW of jct. with Co. Rd. 63, Rochester

Historic Significance:	Architecture/Engineering
Architectural Style:	Federal
Area of Significance:	Architecture
Period of Significance:	1800-1824, 1825-1849, 1850-1874, 1875-1899
Owner:	Private
Historic Function:	Domestic
Historic Sub-function:	Single Dwelling
Current Function:	Domestic
Current Sub-function:	Single Dwelling



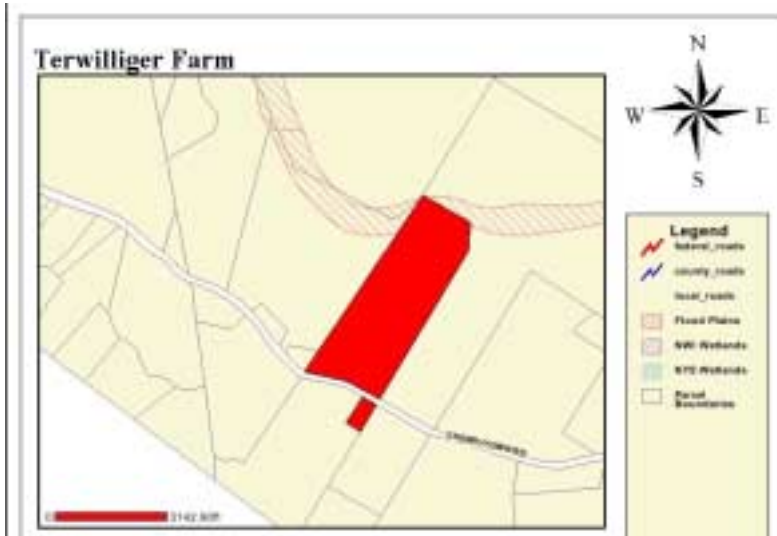

Terwilliger-Smith Farm
 160 Cherrytown Road
 76.1-1-21
 21.3 acres



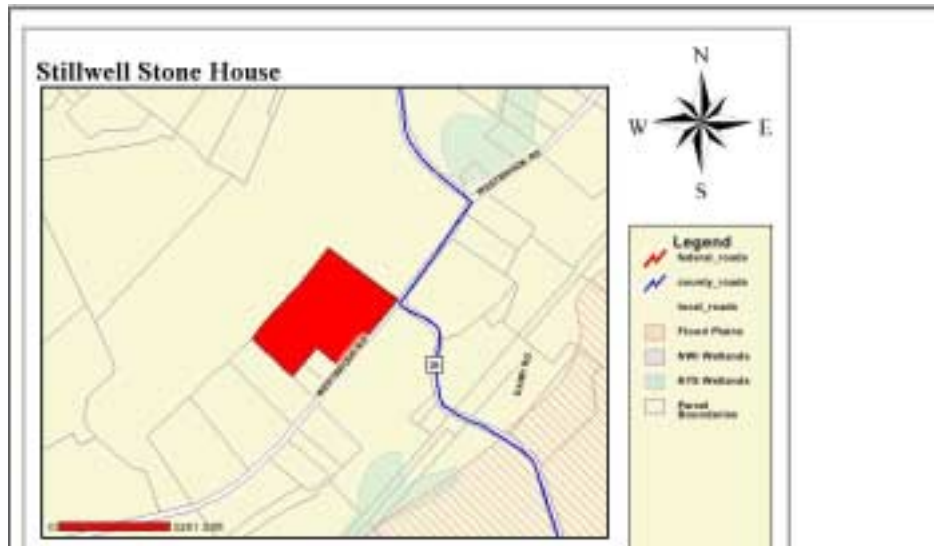

69.3-3-18

412 Old Kings Highway (Westbrook Rd.) (Formerly 189 Old Kings Hwy)

17.5 acres

Stillwell Stone House (added 1999 - **Building** - #99000996)

189 Old Kings Highway, Rochester

Historic Significance:

Architecture/Engineering

Architectural Style:

Federal

Area of Significance:

Architecture

Period of Significance:

1750-1799, 1800-1824, 1825-1849, 1850-1874

Owner:

Private

Historic Function:

Agriculture/Subsistence, Domestic

Historic Sub-function:

Animal Facility, Single Dwelling, Storage

Current Function:

Agriculture/Subsistence, Domestic

Current Sub-function:

Animal Facility, Single Dwelling, Storage



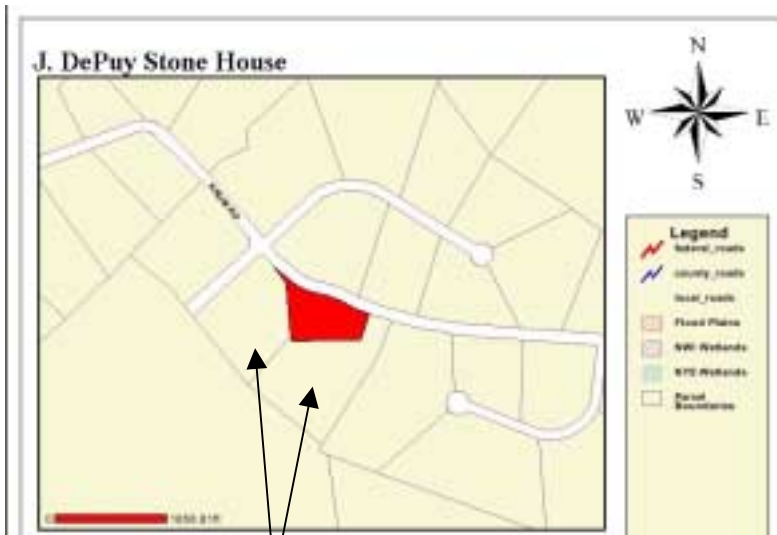

Under Common Ownership

68.3-5-14
200 Krum Road
2.39 Acres

Also owns 68.3-5-13
68.3-5-15

Dupuy, J., Stone House (added 1997 - **Building** - #97000110)
Krum Rd., W of jct. with Queens Hwy., Rochester
Historic Significance: Architecture/Engineering
Architectural Style: No Style Listed
Area of Significance: Architecture
Period of Significance: 1825-1849
Owner: **Private**
Historic Function: Domestic
Historic Sub-function: Single Dwelling
Current Function: Domestic
Current Sub-function: Single Dwelling



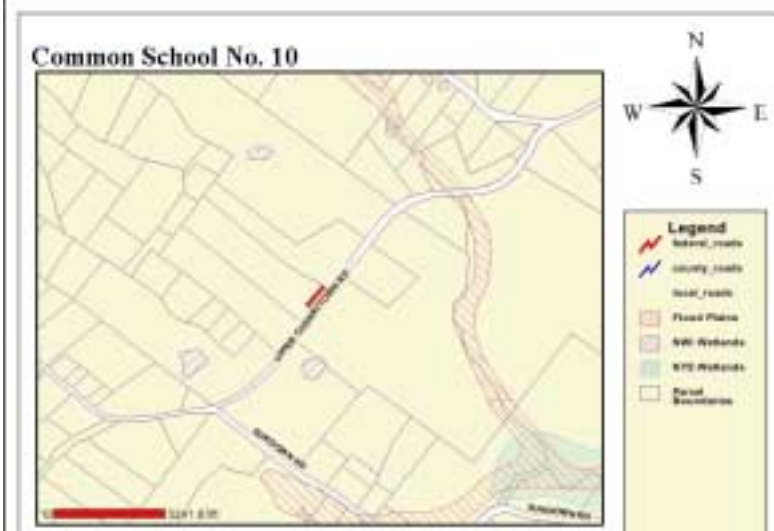

Town of Rochester
 59.8-1-11
 In front of 190 Palentown Road

Common School No. 10 (added 1988 - **Building** - #88001439)

Northside of Upper Cherrytown Rd., Accord

Historic Significance:

Architect, builder, or engineer:

Architectural Style:

Area of Significance:

Period of Significance:

Owner:

Historic Function:

Historic Sub-function:

Current Function:

Event, Architecture/Engineering

Dymond, Horace

No Style Listed

Education, Architecture

1850-1874

Local Gov't

Domestic, Education

School, Secondary Structure

Government

